

BF-D

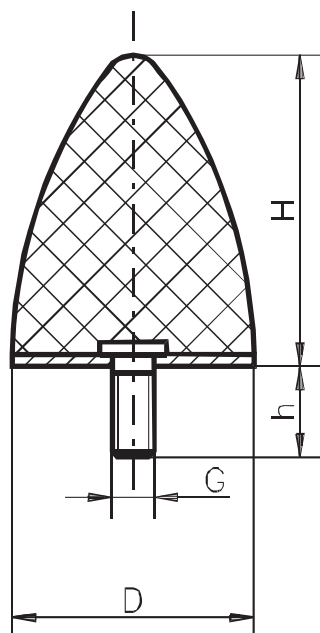

BF-E

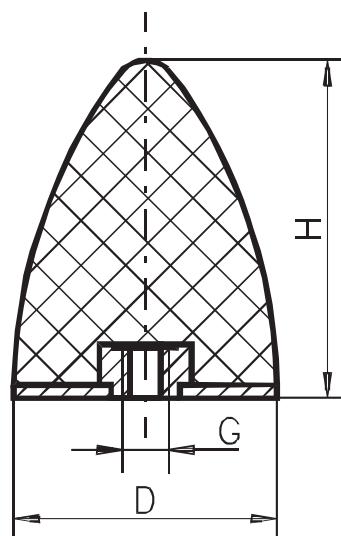

| D/H | D | H | h | G | Макс. Нагрузка, кг | Твердость по Шору |
|--------|-----|----|----|-----|--------------------|-------------------|
| 10/10 | 10 | 10 | 12 | M5 | 15 | 55 |
| 10/15 | 10 | 15 | 10 | M6 | 20 | 55 |
| 20/24 | 20 | 24 | 18 | M6 | 60 | 55 |
| 25/16 | 25 | 16 | 18 | M6 | 75 | 55 |
| 25/20 | 25 | 20 | 18 | M6 | 92 | 55 |
| 30/30 | 30 | 30 | 20 | M8 | 115 | 55 |
| 30/36 | 30 | 36 | 20 | M8 | 140 | 55 |
| 35/40 | 35 | 40 | 23 | M8 | 190 | 55 |
| 50/50 | 50 | 50 | 28 | M10 | 280 | 55 |
| 50/61 | 50 | 61 | 28 | M8 | 360 | 55 |
| 50/67 | 50 | 67 | 33 | M8 | 400 | 55 |
| 50/68 | 50 | 68 | 38 | M10 | 575 | 55 |
| 70/58 | 70 | 58 | 32 | M12 | 780 | 55 |
| 75/89 | 75 | 89 | 37 | M12 | 900 | 55 |
| 95/80 | 95 | 80 | 42 | M16 | 1150 | 55 |
| 118/77 | 118 | 77 | 41 | M16 | 1300 | 55 |